

FORM NO 1.

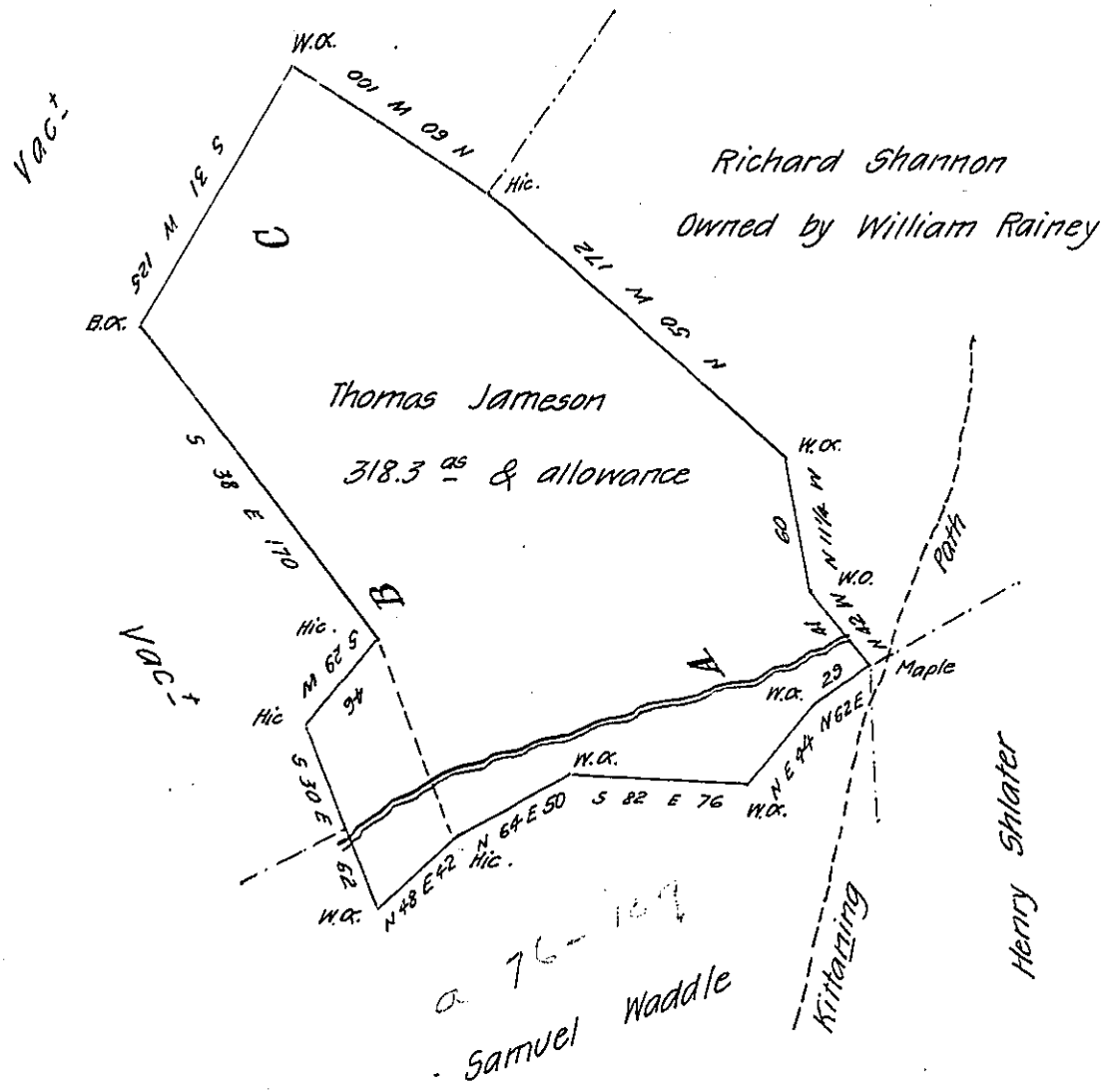

The dotted lines and the letters A.B.C. represent the Survey made to James Simpson on the 21<sup>st</sup> day of February 1828 a return whereof is herewith enclosed. It will be seen by the above diagram that the location of Simpson has been laid upon the ground described. It calls for land on the West side of William Rainey-it <sup>has</sup> been so laid. John McCready ~~owns~~ resides upon this tract and claims under the title to Thomas Jamison which is patented.

John Taylor D. S.

To Gabriel Heister Esquire

Surveyor General.

IN TESTIMONY that the above is a copy of the original remaining on file in the Department of Internal Affairs of Pennsylvania, made conformably to an Act of Assembly approved the 16th day of February, 1833, I have hereunto set my Hand and caused the Seal of said Department to be affixed at Harrisburg, this twenty ninth day of January 1908

*Henry Howell*  
 Secretary of Internal Affairs.